

# SWITZERLAND

Phone: +41 (0) 43 931 61 68  
AFTN: LSSAYOYX  
Email: aip@skyguide.ch

skyguide

AIP SUP: 001/2025

Effective Date: 23-JAN-2025

Publication Date: 23-JAN-2025

AIP Services  
P.O. Box  
CH-8602 Wangen bei Dübendorf  
Switzerland

## Zurich Airport (LSZH) - Project "Reconstruction Apron South - Phase B1 - TWY- E7"

Construction Work 2025 and 2026 - active Phase will be published by NOTAM.

### Phase I:

- TWY E BTN TWY E7 AND TWY E8 WIP. TAX ON TEMP MARKED CL. NO CL LGT PROVIDED. TAX WITH CTN
- TEMP TWY E RESTRICTED TO CODE E ONLY. MAX WING SPAN 65M.

Overview Phase I:

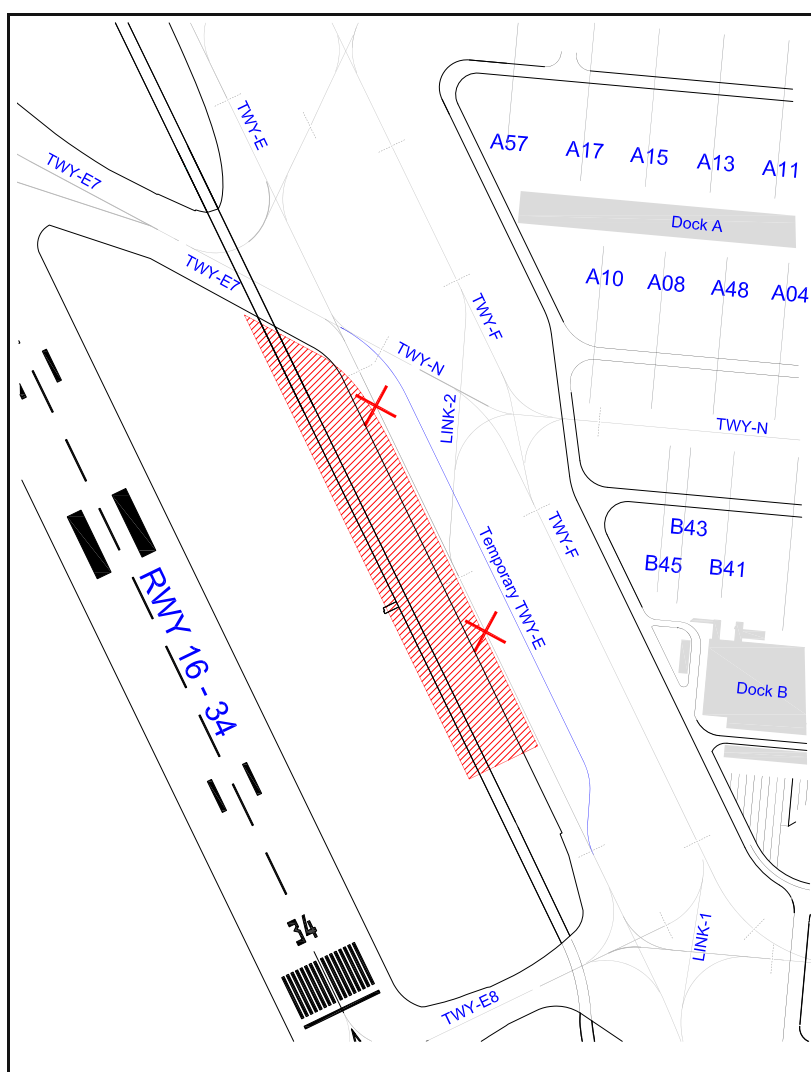

---

**Phase II:**

- TWY E SOUTH OF TWY E7 RESTRICTED TO CODE E ONLY. MAX WING SPAN 65M.
- TWY E BTN TWY E7 AND TWY LINK-2 CLSD DUE TO WIP.
- TWY N CLSD BTN TWY E7 AND TWY F CLSD DUE TO WIP.
- TWY LINK-3 CLSD. TAX ON TEMP MARKED CL LINK-3. NO CL LGT PROVIDED. TAX WITH CTN.

Overview phase II:

